



SPECIFICATION SHEET 25 FT

7.65 M (25' x 8' x 10,5') Accommodation Module

A60 Offshore Accommodation Module offering Safe and Comfortable living for 3 persons.

Specifications:

- Certified to DNV 2.7-1 / DNV2.7-2 / EN 12079
- Lloyd's Certification Scheme (Zone II optional)
- Airlock System – over pressurized cabin
- 1 x Bunk Bed, 1 x single bed
- Lockers including shelving, open top
- Separate wet cabins for shower & toilet
- HVAC -15° / +35° C
- Fire & Gas unit (standard PLC in CPGF)
- High quality fixtures
- Plug and Play, Linkable Hook Up
- Stacking 4 high fixed by twist lock
- Manufactured in house to ISO 9001
- Modules available for hire or sale

Dimensions

LOA 7.65 m x WOA 2.44 m x HOA 3.20m

Weight

7.100 Kg

Certification

IMO-/SOLAS, IMO 754-18 A60,
DNV 2.7-1 / DNV 2.7-2
EN 12079 (1&2)
Norma Regulamentadora (NR 10 – NR 30)

Titan Offshore Modules NL

Tel: +31 (0) 20 820 23 38

Tel: +31 (0) 62 246 25 49

Tel: +31 (0) 65 171 77 36

info@titanmodules.com

www.titanmodules.com



Brazilian NRs 10 - 30
Brazilian Regulatory Standards on Health and Safety at Work



SPECIFICATION SHEET

Indicative Floorplan 25 FT

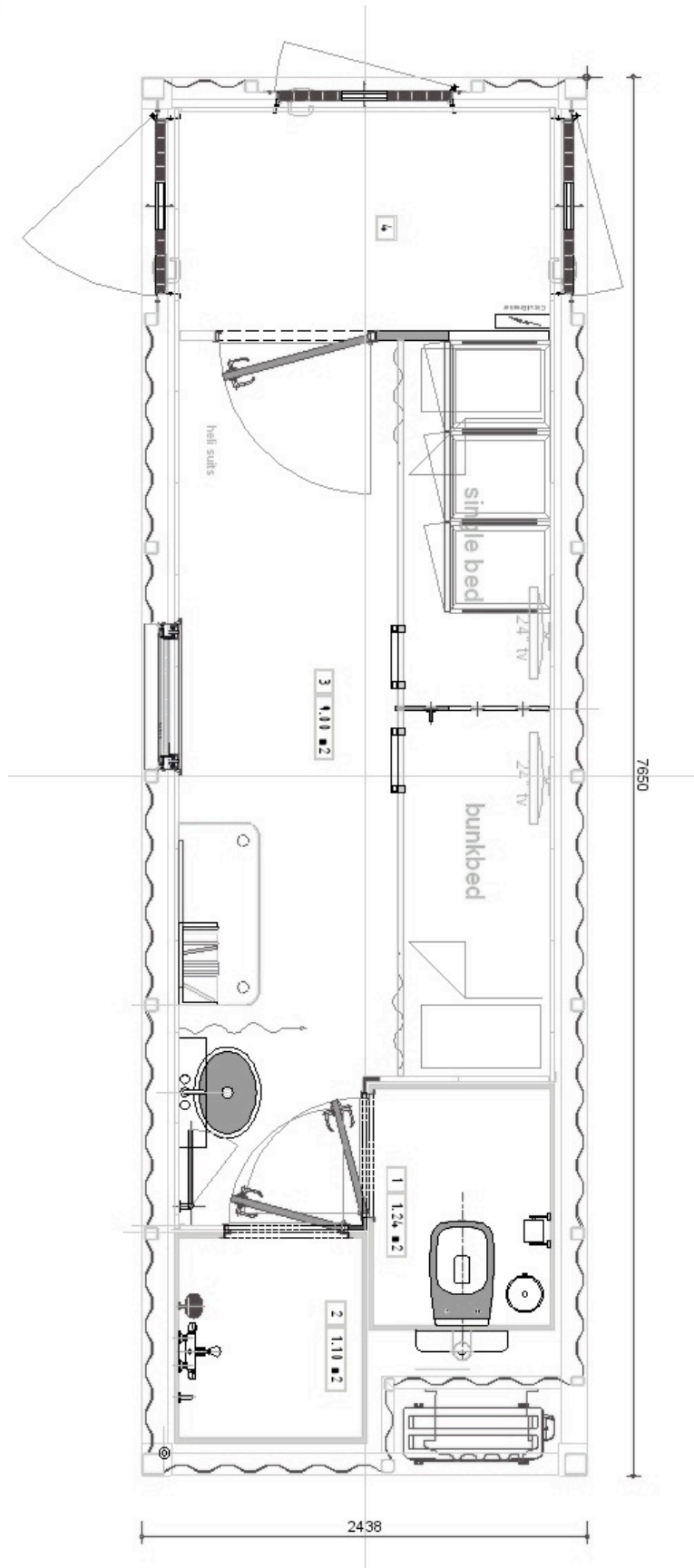

Brazilian NRs 10 - 30
Brazilian Regulatory Standards on Health and Safety at Work